

# BIOJET™ Floating Decanter



## Series FD

GERUM Div. Technique Environment has over 25 years of experience in manufacturing, design and installation of floating decanters. GERUM TE's R&D has developed a floating decanter with minimized maintenance intervals and optimized decanter flow and life time. An important part of the system is its robust nature. Energy consumption is negligible due to little winding time per decanting cycle.

During the biological processes aeration, mixing and sedimentation the skimmer with floating cell of the **BIOJET™ FD** is winded up and stays in over flow position. Depending on the process the winder lowers the decanting head to the water surface during or at the end of the sedimentation process to start the decanting cycle. In order to prevent discharging of floated sludge or foam the skimmer is immersed under the water surface (immersion depth adjustable up to 200 mm). After the decanting process the winder lifts the decanting head to the initial position, which is also the over flow (emergency overflow) position. For additional safety, a safety stainless steel cable is installed.



Wind up position

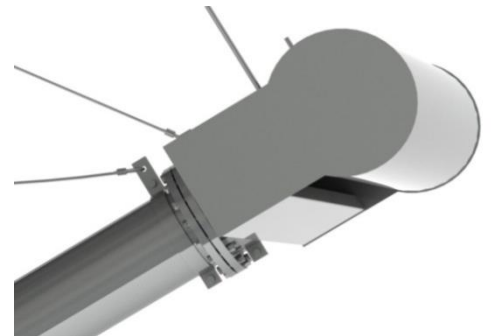

Floating cell with skimmer

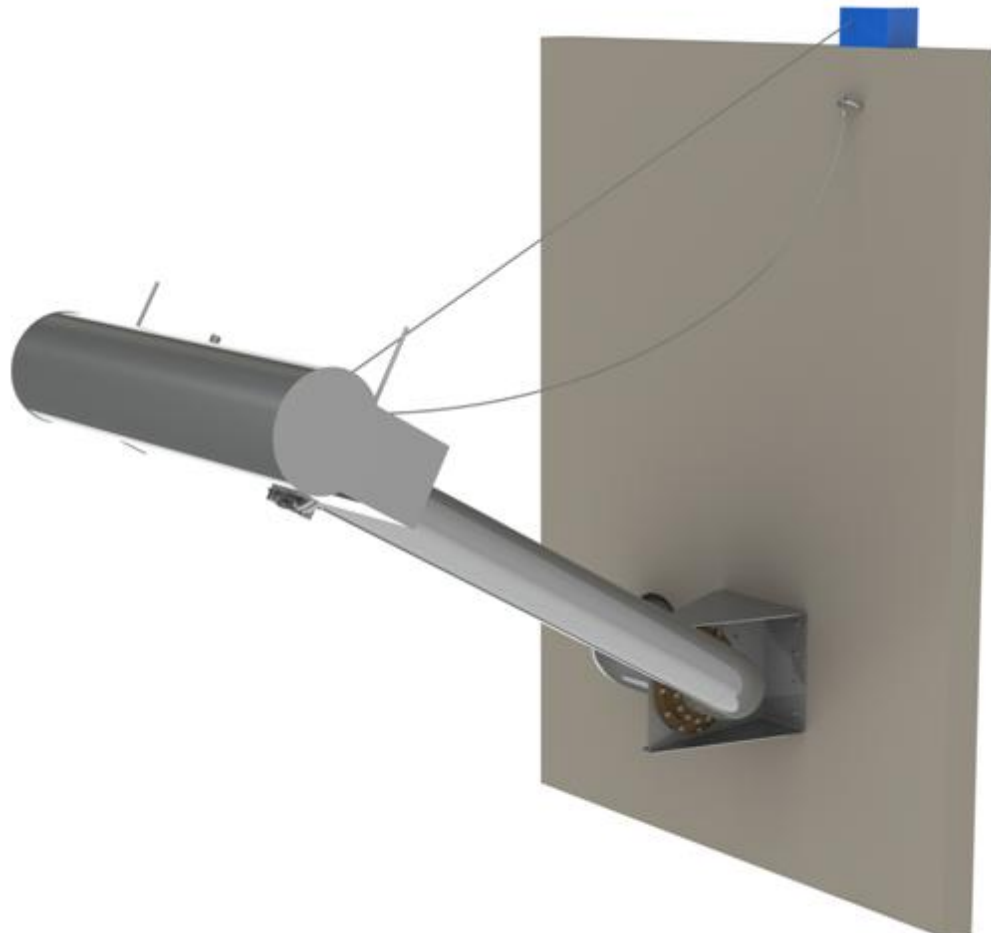

## FEATURES

- HIGH EFFICIENCY FLOATING DECANTER
- RETROFITTING OF EXISTING SBR PLANTS
- ADJUSTABLE IMMERSION DEPTH up to 200 mm
- IMMERSED SKIMMER TO PREVENT DISCHARGE OF FLOATING SLUDGE & FOAM
- AVAILABLE IN MATERIAL AISI 304 or AISI 316 L
- AVAILABLE FROM 40 – 400 l/s DECANTING FLOW
- FLOATING SKIMMER WITH ADJUSTABLE IMMERSION DEPTH
- DECANTER ALSO USED AS EMERGENCY OVER FLOW
- MAINTENANCE FREE SWIVEL JOINT
- NEGLIGIBLE ENERGY CONSUMPTION
- MINIMAL MAINTENANCE
- SELF LUBRICATED WINDER and STAINLESS STEEL ROPE
- LIFE SPAN OF OVER 20 YEARS
- NO DISTURBANCE OF FLOW DURING AERATION AND MIXING (NITRIFICATION AND DENITRIFICATION)
- SAFE OPERATION
- POSSIBLE DECREASE IN DECANTING TIME FROM 1 HOUR DOWN TO 30 MINUTES
- **BIOJET™** FD IS A GERMAN MADE PRODUCT
- **BIOJET™** DI FIXED DECANTERS ON REQUEST

## TECHNICAL DATA

Material	AISI 304 or AISI 316 on request
Decanting volume	40 - 450 l/s
Discharge pipe diameter	∅ 100 – 500 mm
Winch	0,37 - 2,2 kW
Motor	400 V, 50 Hz (230 V on request)
Speed	2,4 – 3,5 m / min

**DECANTER SIZE**

<i>Model</i>	<i>Decanting volume</i>	<i>Pipe Ø</i>	<i>L1 (max) mm</i>	<i>L2 mm</i>	<i>H1 (min) mm</i>
<b>FD 100</b>	up to 50 l/s	DN 100	3000	1500	500
<b>FD 150</b>	up to 75 l/s	DN 150	3500	1500	500
<b>FD 200</b>	up to 110 l/s	DN 200	4500	2000	500
<b>FD 250</b>	up to 180 l/s	DN 250	4500	2000	600
<b>FD 300</b>	up to 280 l/s	DN 300	5000	2500	700
<b>FD 350</b>	up to 300 l/s	DN 350	5500	2500	700
<b>FD 400</b>	up to 360 l/s	DN 400	5500	3000	900
<b>FD 500</b>	on request				

L1 relating on tank dimension

